

Addition of a Logo to CC-Link IE TSN Remote Modules

■Date of Issue

April 2021

■Relevant Models

NZ2GN2S1-32D, NZ2GN2B1-32D, NZ2GNCF1-32D, NZ2GNCE3-32D, NZ2GN2S1-32T, NZ2GN2B1-32T, NZ2GNCF1-32T, NZ2GN2S1-32TE, NZ2GN2B1-32TE, NZ2GN2S1-32DT, NZ2GN2B1-32DT, NZ2GNCE3-32DT, NZ2GN2S1-32DTE, NZ2GN2B1-32DTE, NZ2GN2S-60AD4, NZ2GN2B-60AD4, NZ2GN2S-60DA4, NZ2GN2B-60DA4

Thank you for your continued support of Mitsubishi Electric programmable controllers.

The CC-Link IE TSN remote modules manufactured on and after October 2019 have supported the CC-Link IE Field Network communication mode. Therefore, the modules can also be used as a CC-Link IE Field Network remote module.

To clarify the above matter, the logo of "CC-Link IE Field" will be added on the front of the relevant modules.

There is no impact on the general specifications, performance specifications, and functions of products due to the change.

1 DETAILS ON THE CHANGE

1.1 Position of the Logo (for the NZ2GN2S1-32D)

The logo of "CC-Link IE Field" is added on the front of the module as follows.

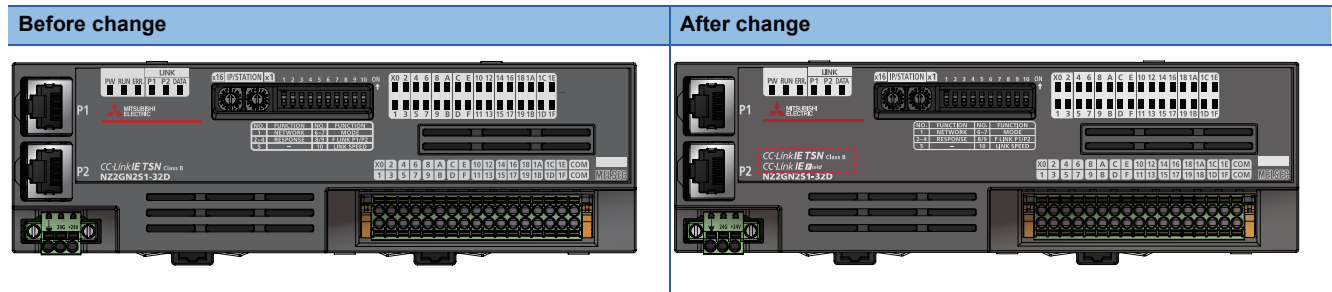

The position of the logo may differ depending on the model.

2 APPLICABLE MODELS AND THE VERSION AFTER CHANGE

The following table lists the version after addition of the logo of "CC-Link IE Field".

The logo is added to all the models which will be released on and after April 2021 and support the CC-Link IE Field Network communication function.

Product		Model	Version after change	
			3rd and 4th digits in the upper side of production information	Location of the production information
CC-Link IE TSN remote I/O module	32-point spring clamp terminal block type	NZ2GN2S1-32D	"03" or later	SERIAL field in the rating plate
		NZ2GN2S1-32T		
		NZ2GN2S1-32TE		
		NZ2GN2S1-32DT		
		NZ2GN2S1-32DTE		
	32-point screw terminal block type	NZ2GN2B1-32D	"03" or later	
		NZ2GN2B1-32T		
		NZ2GN2B1-32TE		
		NZ2GN2B1-32DT		
		NZ2GN2B1-32DTE		
	32-point sensor connector (e-CON) type	NZ2GNCE3-32D	"02" or later	
		NZ2GNCE3-32DT		
	32-point and 40-pin connector type	NZ2GNCF1-32D	"02" or later	
		NZ2GNCF1-32T		
	CC-Link IE TSN analog-digital converter module	Spring clamp terminal block type	NZ2GN2S-60AD4	
Screw terminal block type		NZ2GN2B-60AD4		
CC-Link IE TSN digital-analog converter module	Spring clamp terminal block type	NZ2GN2S-60DA4	"02" or later	
	Screw terminal block type	NZ2GN2B-60DA4		



The CC-Link IE Field Network communication mode is available for the modules with firmware version "02" or later. (The firmware version is indicated by the 2 digits in the upper side of production information.)

3 DATE OF CHANGE

The change will take place one by one for products manufactured on and after May 2021.

Note that, depending on stock status, both the products before and after change may be distributed in the market around that time.

FA-A-0334-A

REVISIONS

Version	Date of Issue	Revision
A	April 2021	First edition

TRADEMARKS

The company names, system names and product names mentioned in this technical bulletin are either registered trademarks or trademarks of their respective companies.

In some cases, trademark symbols such as [™] or [®] are not specified in this technical bulletin.